

REVISIONS				
ZONE	REV	DESCRIPTION	DATE	APPROVED
S.D.	1	Release For Production	10/26/07	

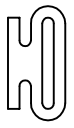

Reference
Tolerance: 5% commercial

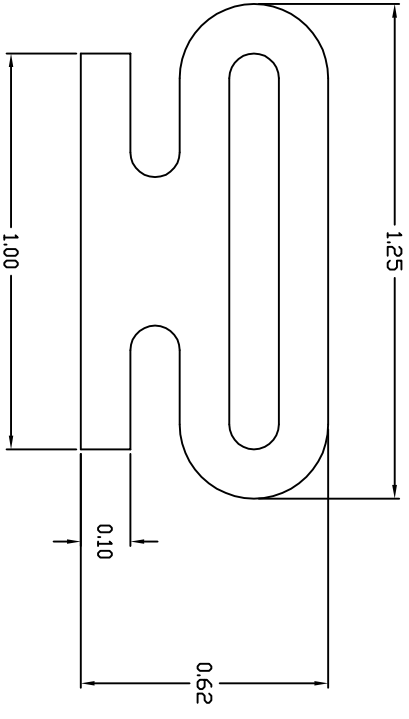

1750 Elk Grove Village, IL 60007
Tel: 847-758-0241
Fax: 847-758-0254

Part Number: DR-2

CONFIDENTIAL: This document contains information which is proprietary to DRI, and should be protected accordingly.

SCALE	SIZE	FIG. NO.	DWG. NO.	SHEET	REV
				1 OF 1	
				1 OF 1	